

SEATTLE METALS // PRODUCT GUIDE

PEOPLE IN OUR PURPOSE // EXCELLENCE IN OUR PRODUCTS // INTEGRITY IN OUR PRACTICE

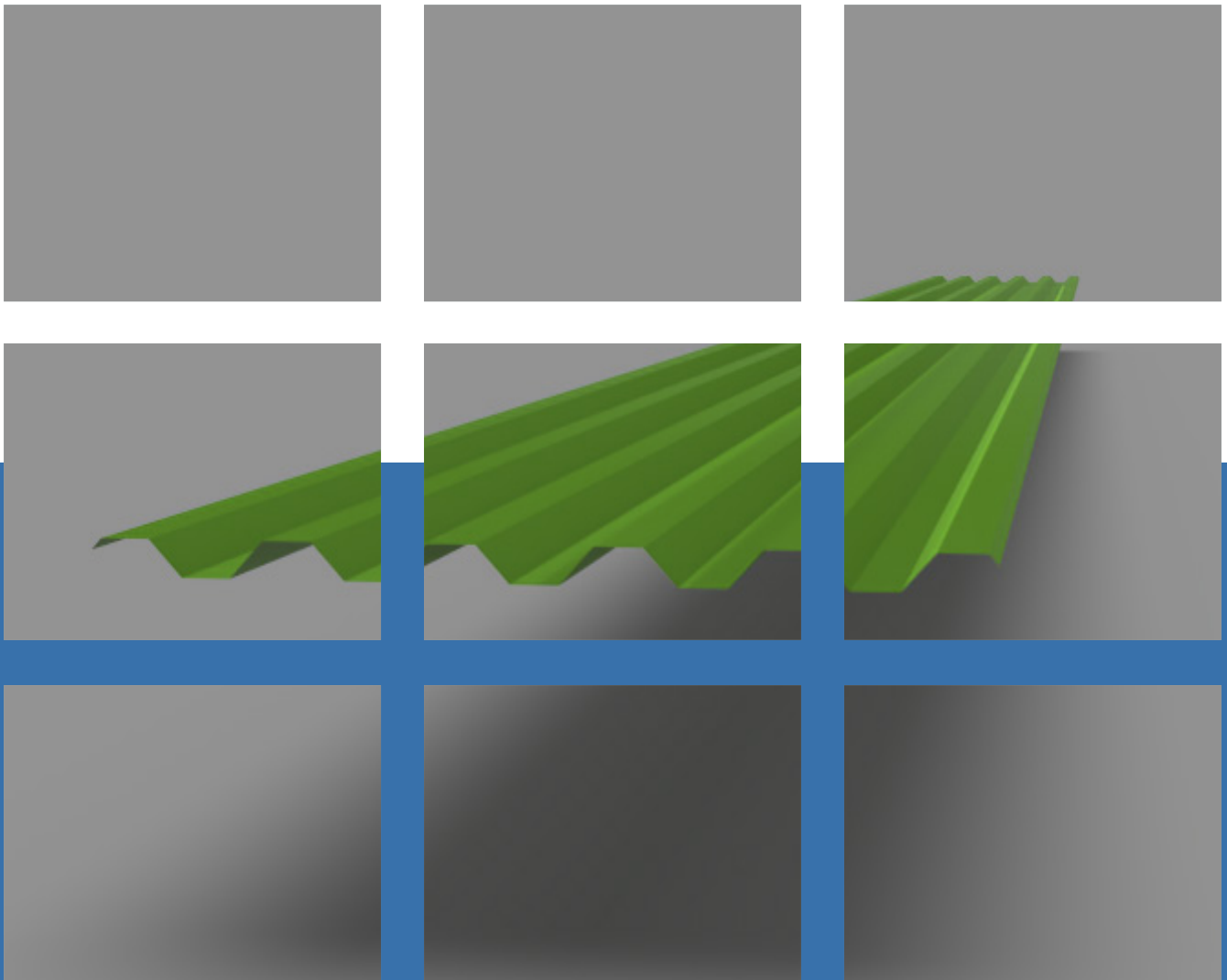

www.SeattleMetalsinc.com



Table of Contents

- 04 WHO WE ARE
- 06 CORNER METALS
- 08 VERTICAL TRANSITIONS
- 10 HORIZONTAL TRANSITIONS
- 12 METAL CAPS
- 13 VENT METALS
- 14 DOOR METALS
- 15 CUSTOM METALS
- 16 METAL BOOTS
- 18 METAL PANEL PROFILES
- 20 AWNINGS
- 21 HOUSE NUMBERS
- 22 COLOR & PATTERN SELECTIONS

WHO WE ARE.

PLANNING

Seeking to deliver on our promise to be our customer's partner, we focus our efforts not just on a project's success, but on our customer's success. With that aim, we develop plans that optimize our in-house capabilities and long term partnerships, while providing a one stop solution for your project needs.

EXECUTION

Bring us your sketches and we will produce your sheet metal products: We provide a variety of custom and standard products
For example; custom products, coping, siding, roofing, door pans, and more

SUPPORT

Our customers are our first priority. It is our objective at Seattle Metals to work with and for our customers to best serve their sheet metal needs. We remain flexible not fixed and love providing expedited results for our customers. We look forward to working with you on your future projects.



PEOPLE IN OUR PURPOSE

HUMILITY THAT PUTS OTHERS FIRST

//

Our company sees the people behind every contract and every order, and seeks to enrich the lives of the people we work with. We value humility and putting other people first in all we do. If you're not in it to serve you won't feel at home at Seattle Metals.

EXCELLENCE IN OUR PRODUCTS

HARD WORK THAT IS RESULTS DRIVEN

//

We understand that a reputation is built over time and can be ruined overnight. We want our customers to reinforce their reputation of quality and timeliness with Seattle Metals. We commit to exceed people's expectations with hard work and continual improvement. At Seattle Metals, excellence is not simply a profit tool. It is a way of life.

INTEGRITY IN OUR PRACTICE

HONESTY THAT GAINS PEOPLE'S TRUST

//

We work with a focus on long-term, sustainable results and seek to cultivate trustworthy and lasting relationships with all the people we work with. Honesty, transparency, and authenticity are principles that we hold to and operate under.

OUR PROMISE

//

We promise to be your trustworthy partner in our mutual success. We want our customer's to receive the kind of care and attention a partner would have. That is our approach. We succeed when they succeed. We win when they win. We promise to act like a partner, and we seek customers who value a partner relationship.



CORNER METALS

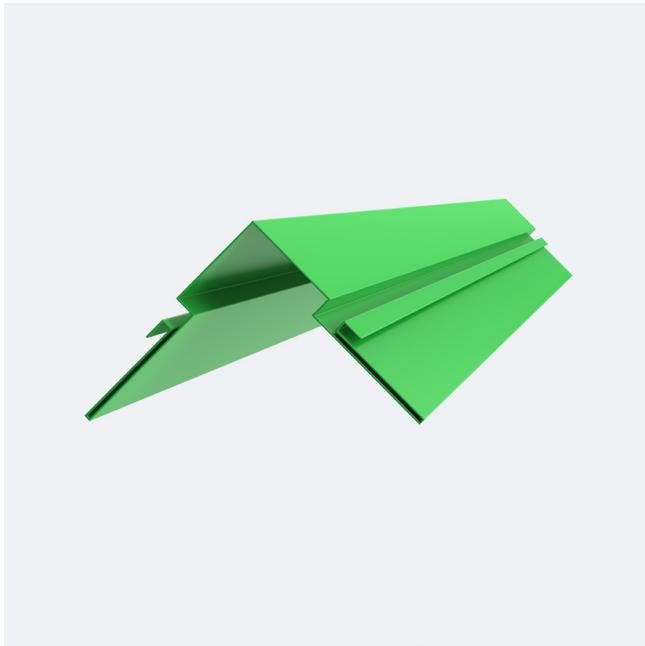

HARDY CUBE OUTSIDE CORNER



HARDY OUTSIDE CORNER

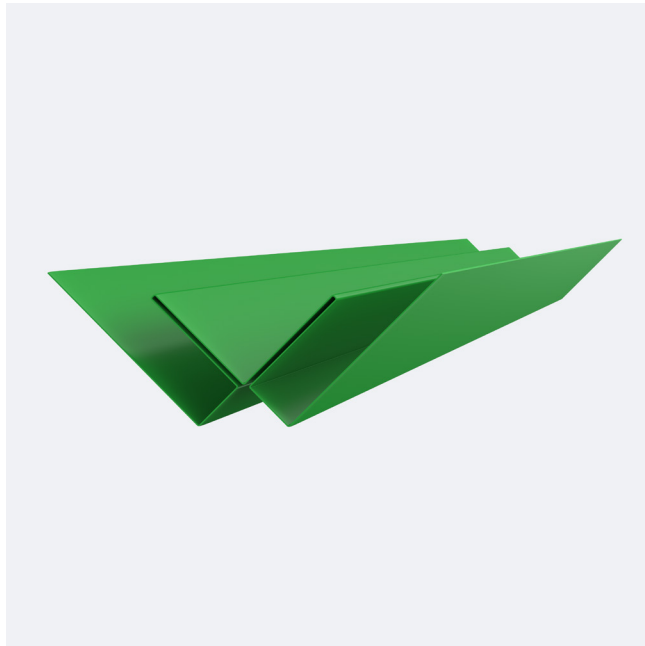

INSIDE HARDY CORNER

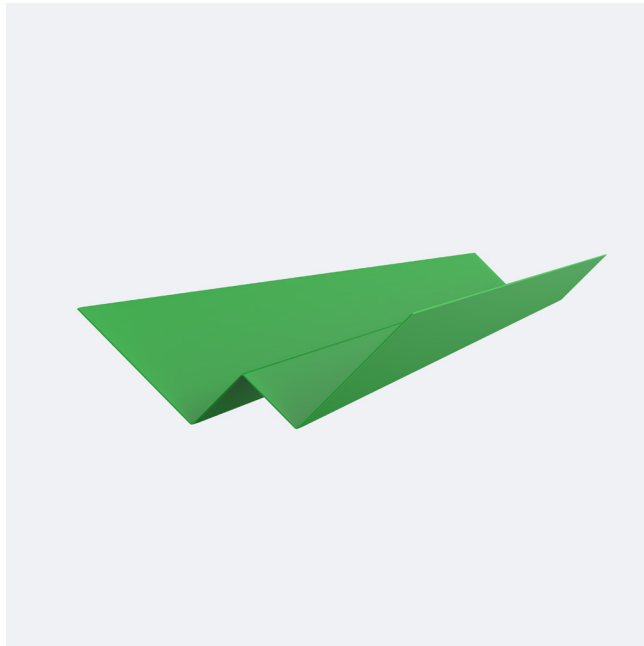

INSIDE CORNER

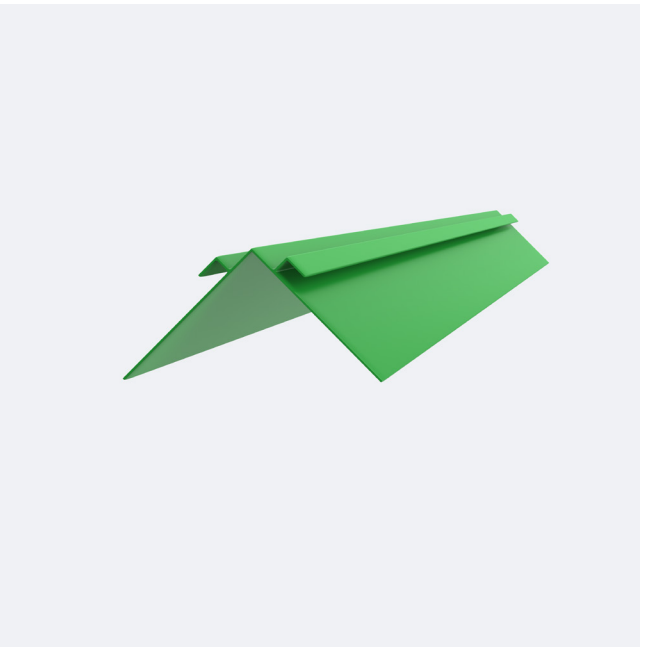

HARDY REVEAL OUTSIDE CORNER



OUTSIDE X-CORNER



OUTSIDE BOX CORNER

VERTICAL TRANSITIONS

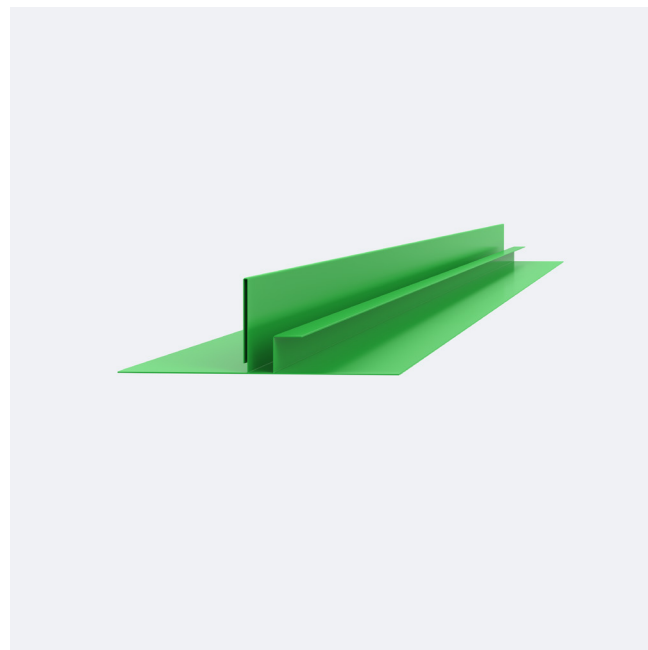

LAZY H-METAL TRANSITION

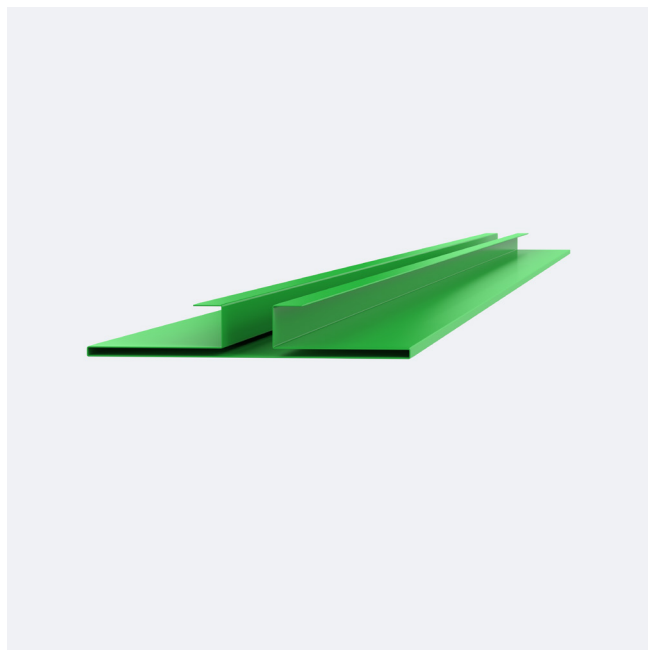

H METAL

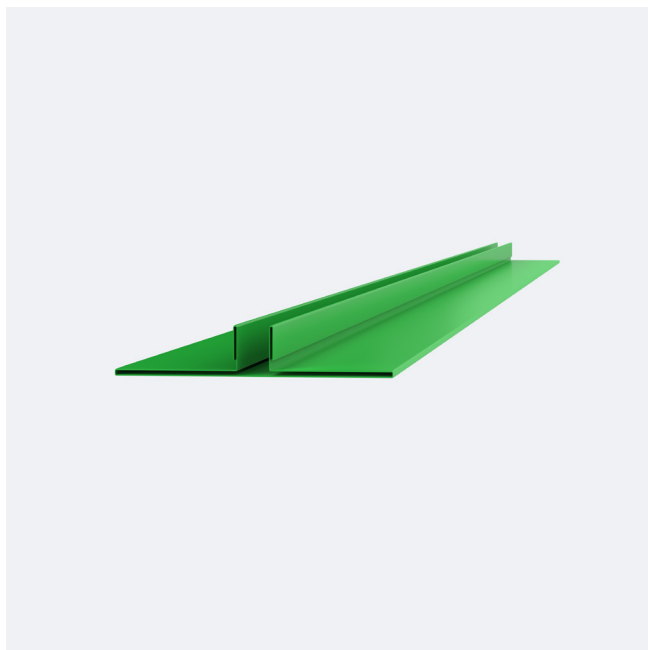

LAZY H-METAL HEMMED

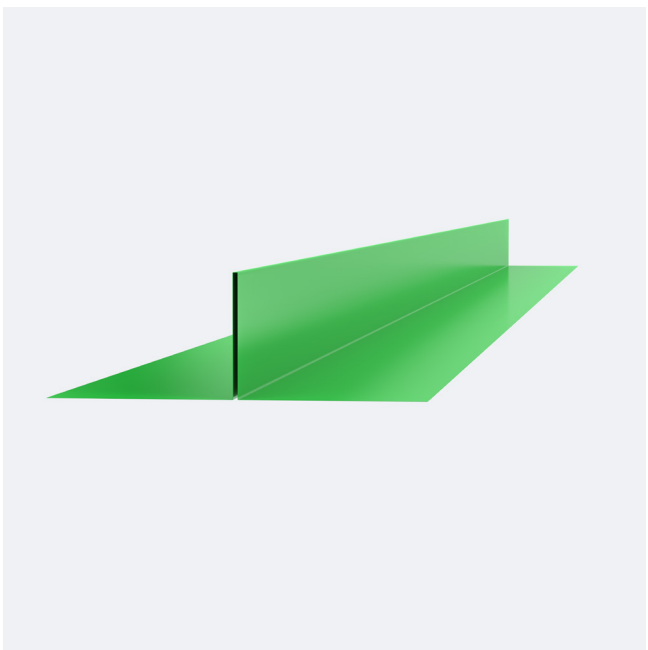

T-METAL

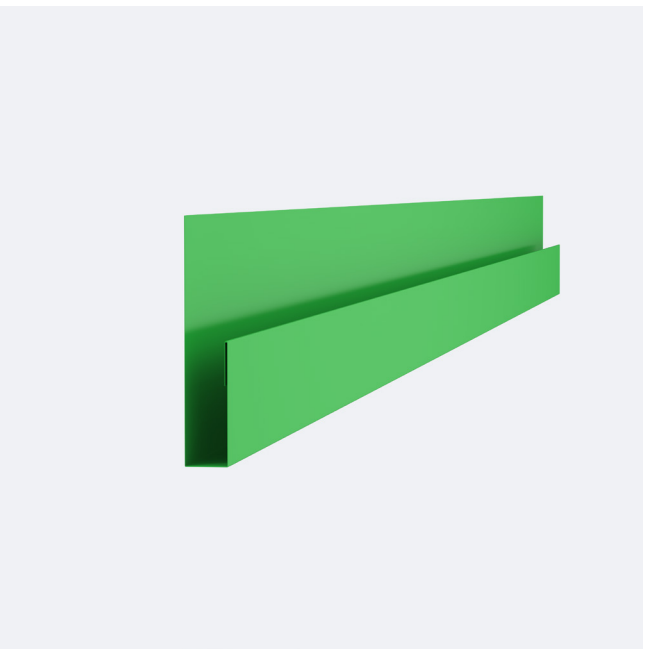

J-METAL HEMMED TRANSITION

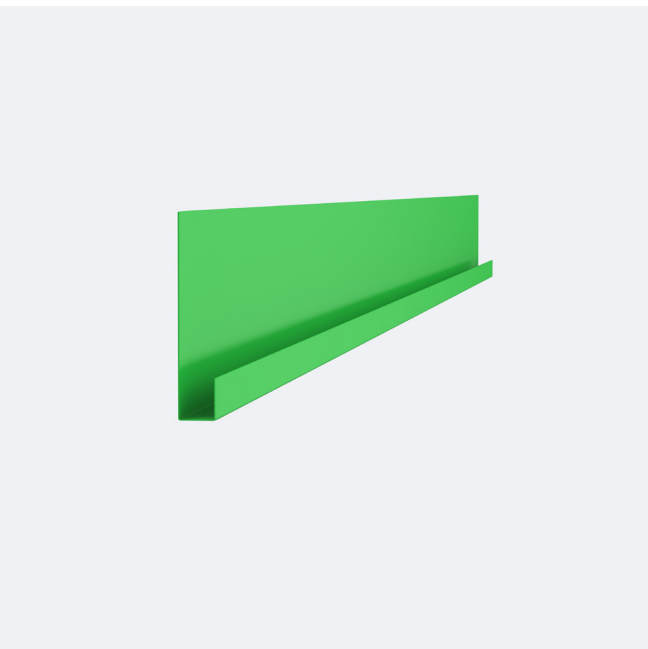

J-METAL

HORIZONTAL TRANSITIONS

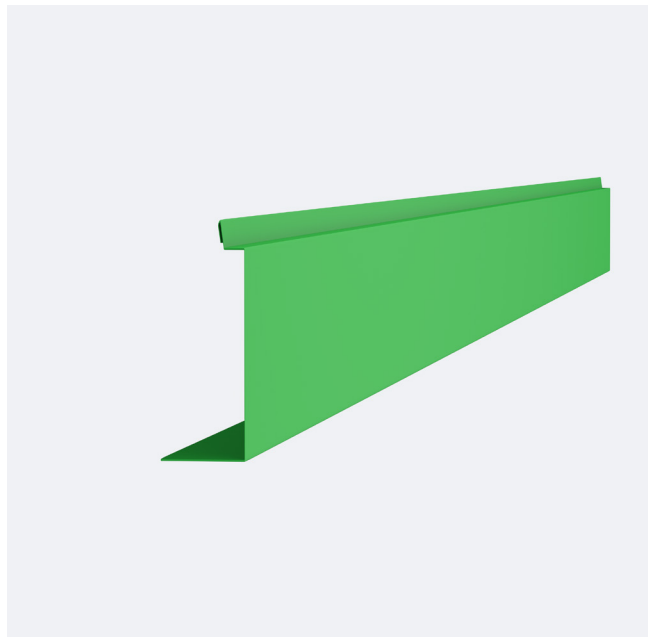

J-METAL TRANSITION

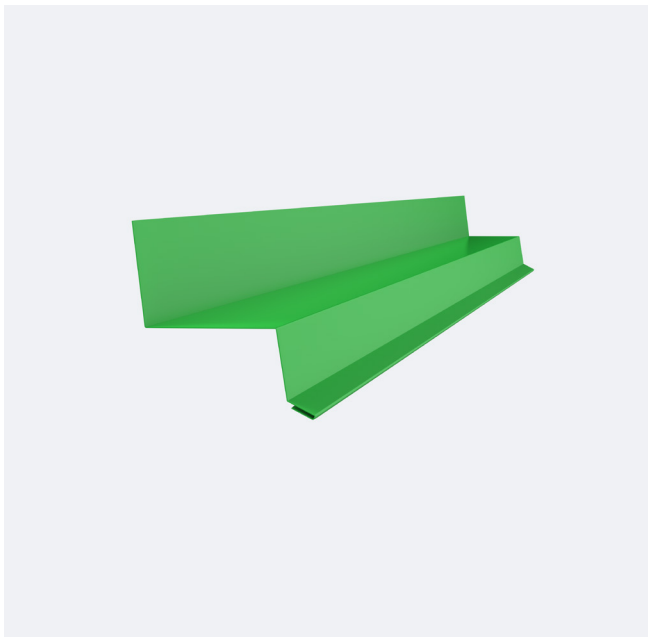

THROUGH WALL WITH DRIP & HEM

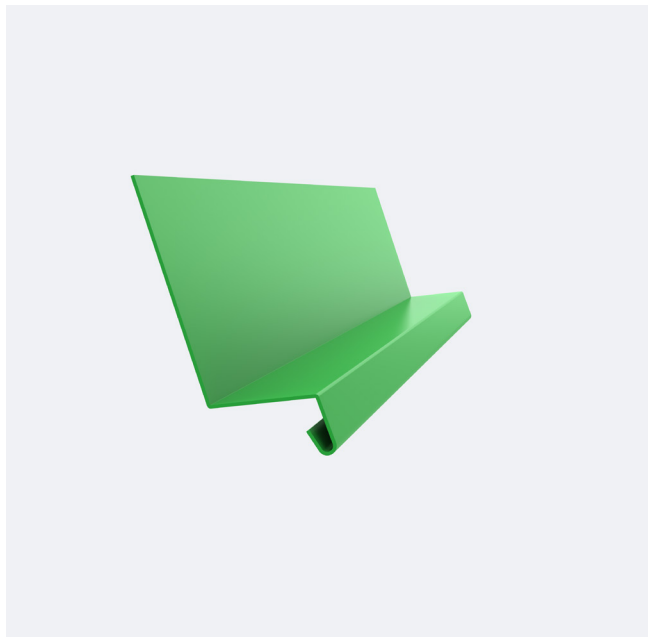

Z FLASHING WITH HEM

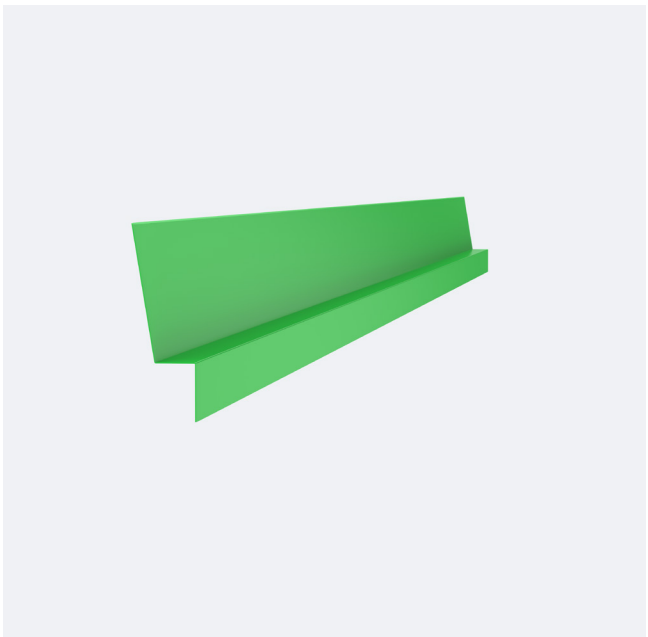

Z HARDY

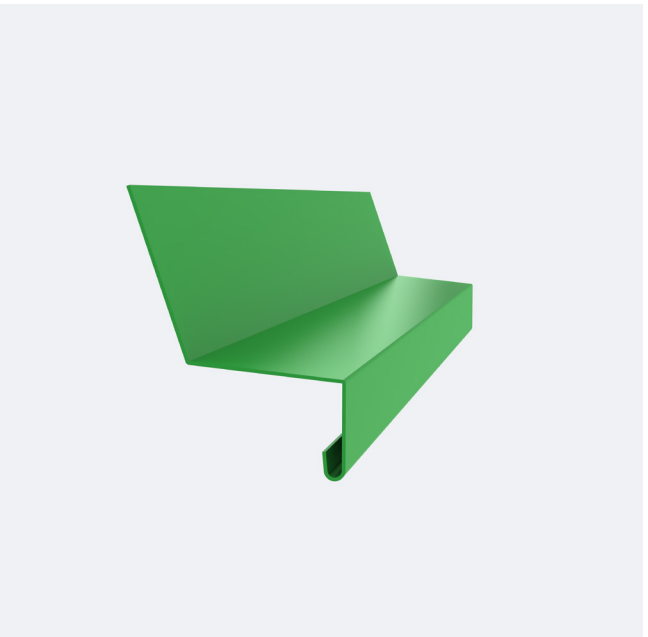

THROUGH WALL WITH HEM



Z-FLASHING

METAL CAPS



COPING



PARAPET COPING (ANGLED)

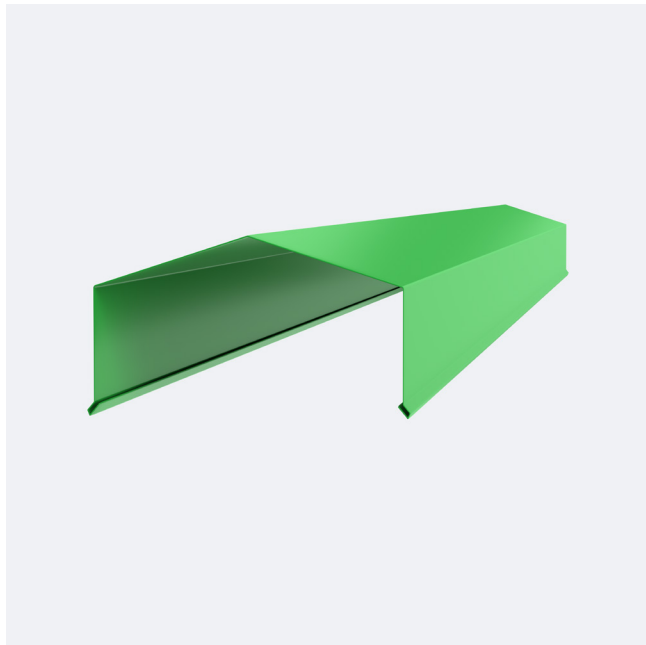

PARAPET CAP WITH DOUBLE SLOPE

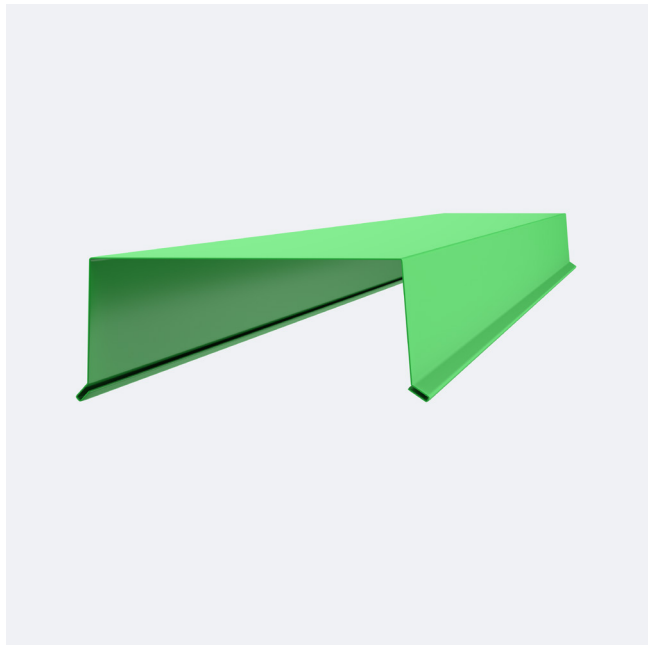

PARAPET COPING

VENT METALS

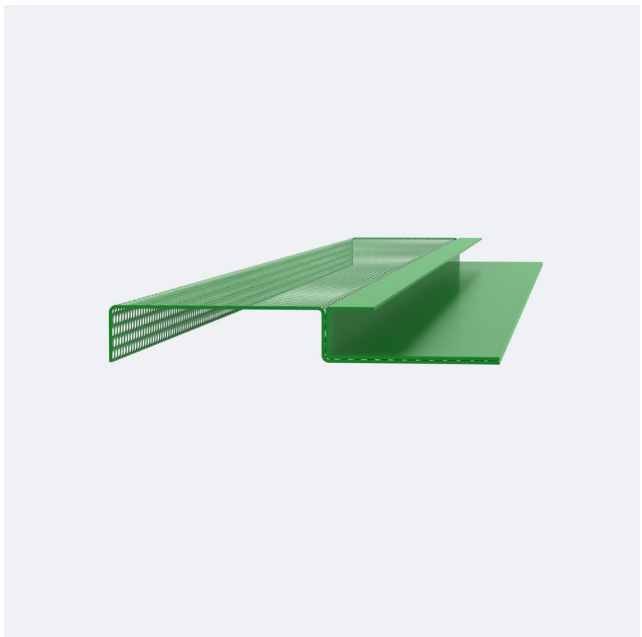

SOFFIT TO WALL METAL

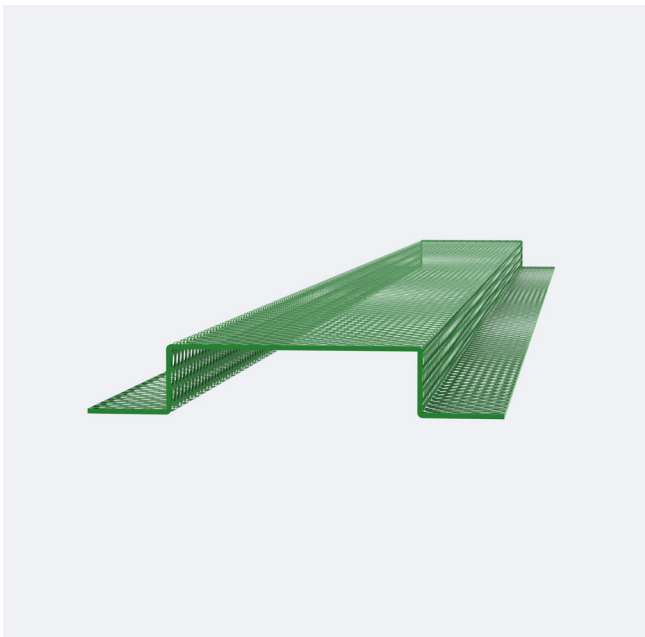

SOFFIT HAT CHANNEL

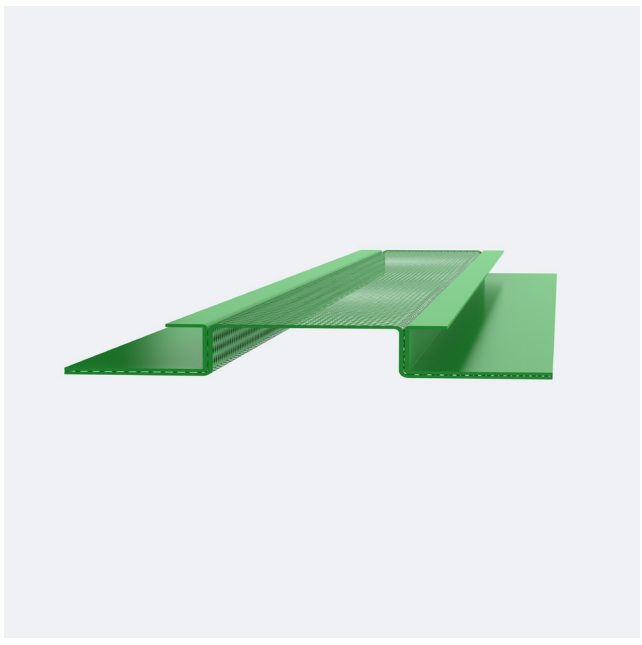

FLUSH SOFFIT H METAL

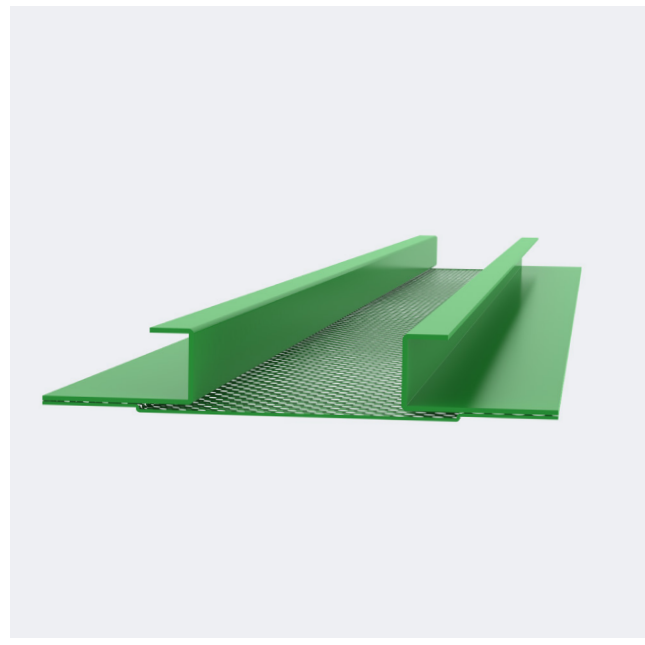

SOFFIT H METAL

DOOR METALS



DOOR METAL OUT

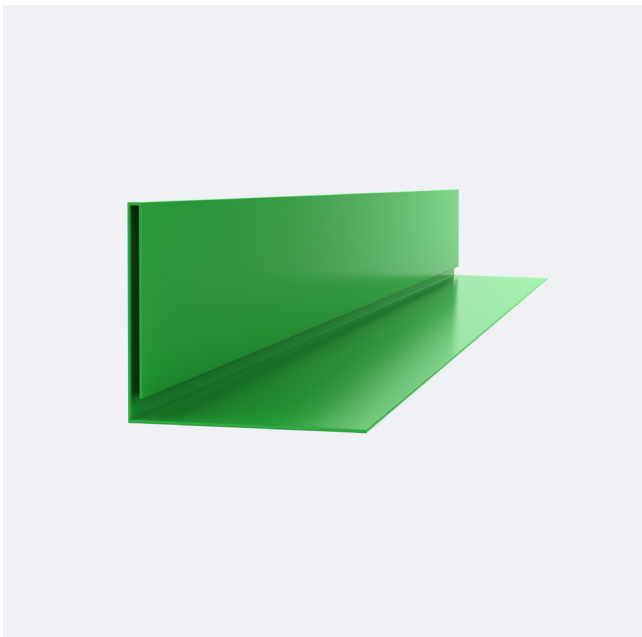

DOOR METAL IN

CUSTOM METALS

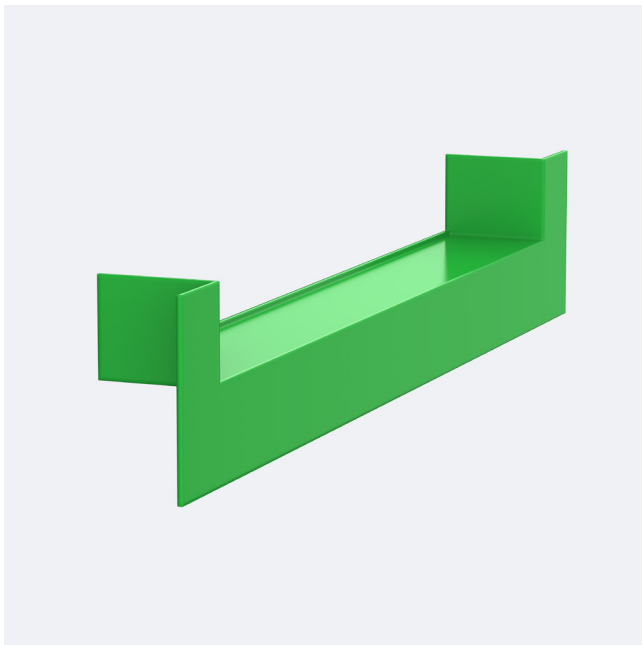

DOOR PAN

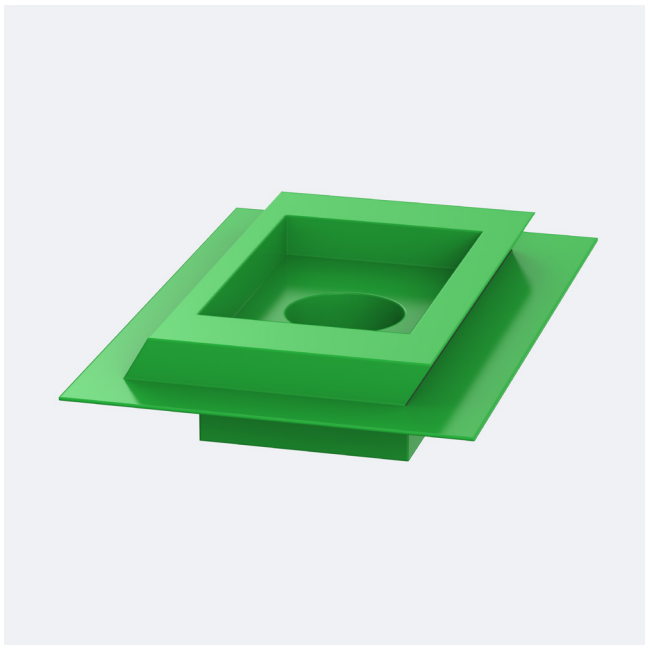

WALL VENT



COLLECTOR BOX

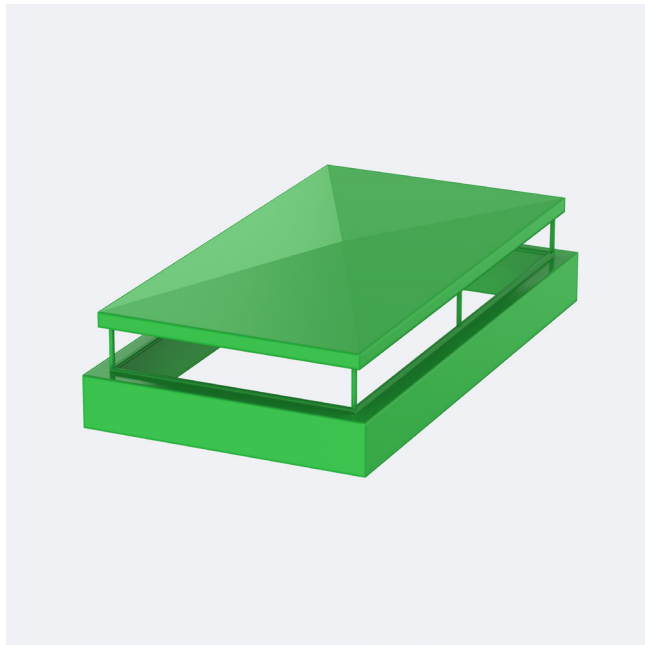

CHIMNEY CAP

CUSTOM METAL BOOTS

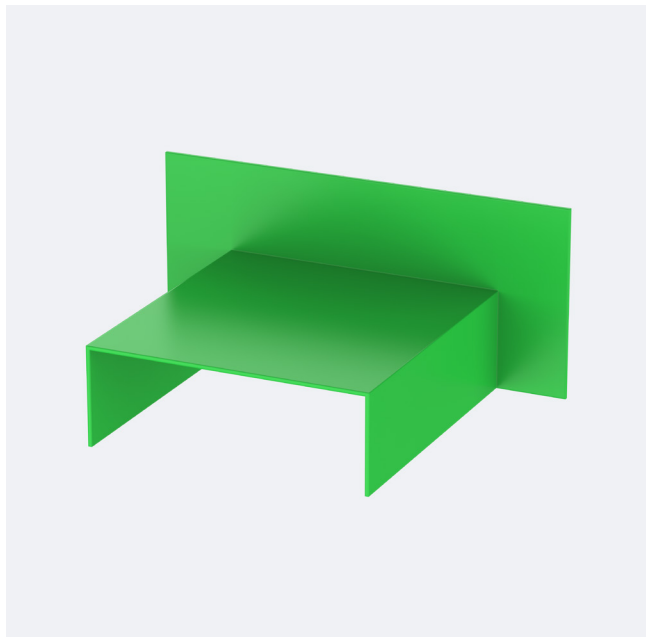

CENTER BOOTS

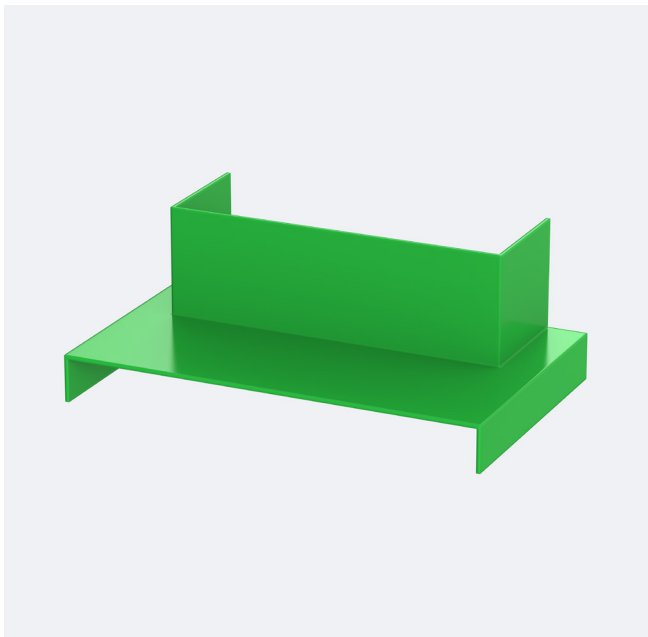

OFFSET BOOT

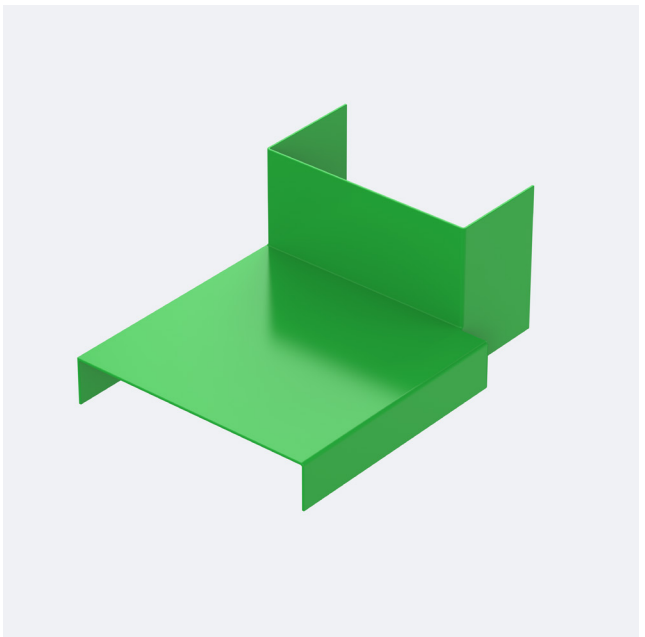

BUMPOUT BOOTS

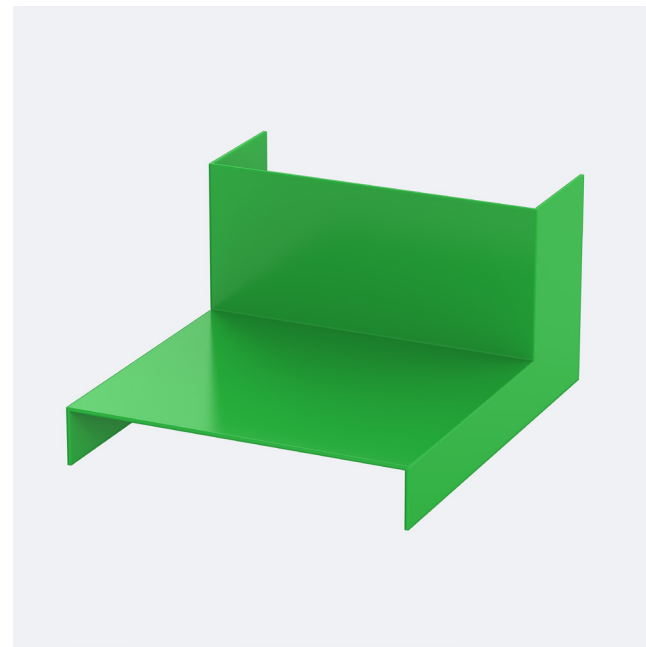

FULL SAIL BOOTS

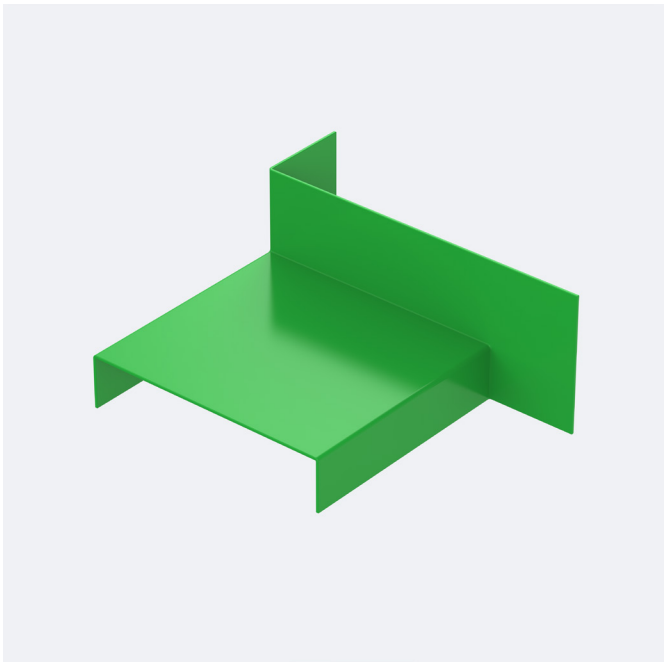

CORNER BOOTS

METAL PANEL PROFILES

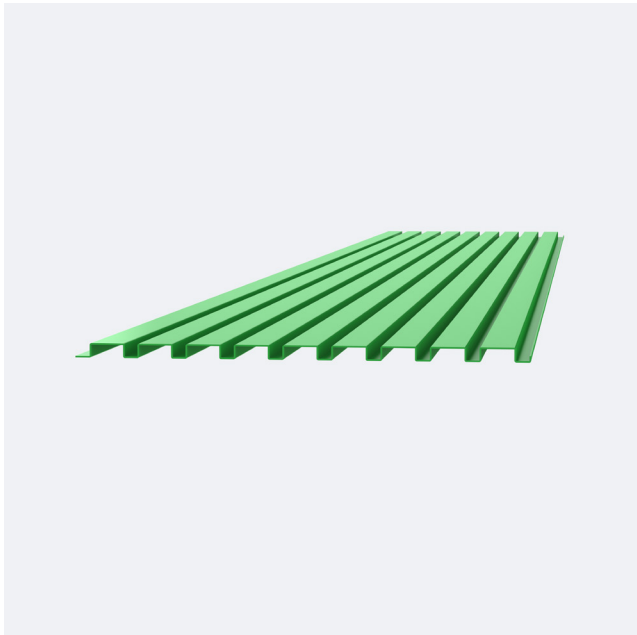

SQUARE RIB PANEL



7.2 RIB PANEL

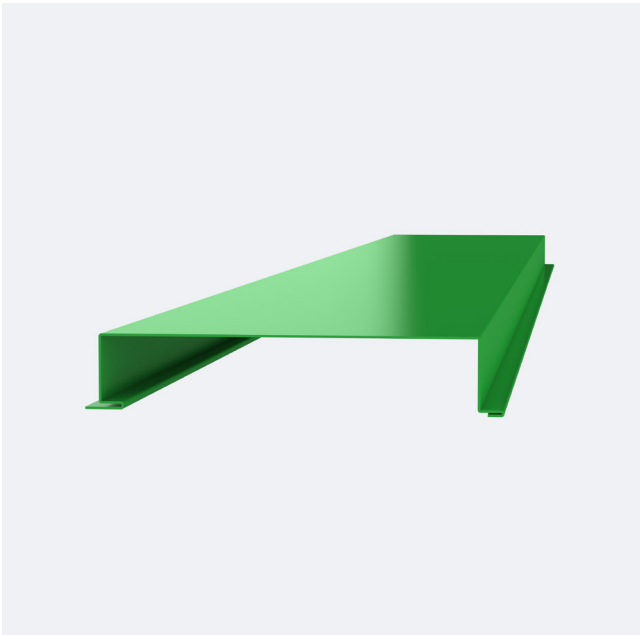

FLUSH PANEL

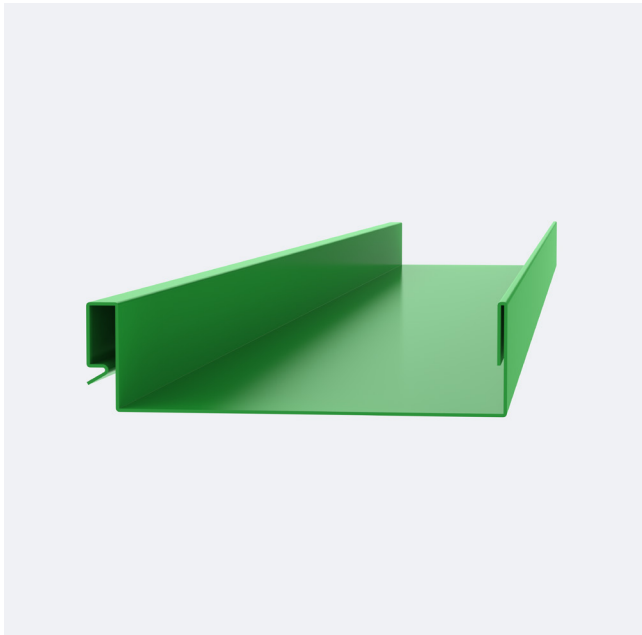

STANDING SEAM PANEL

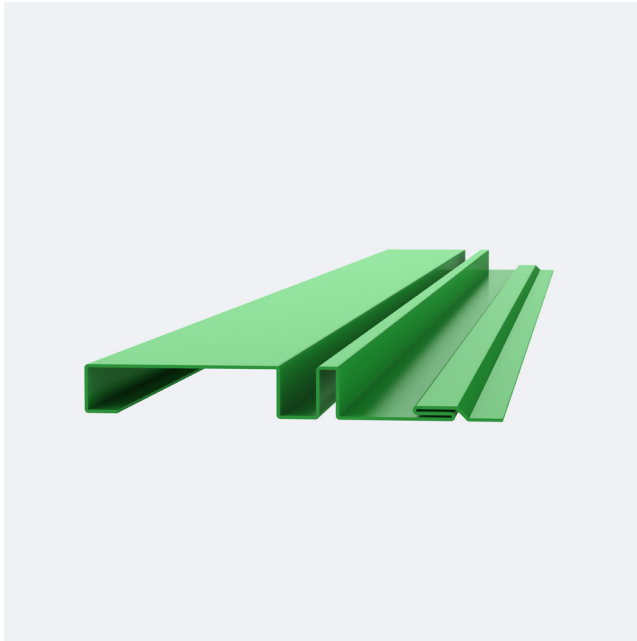

DOUBLE REVEAL PANEL

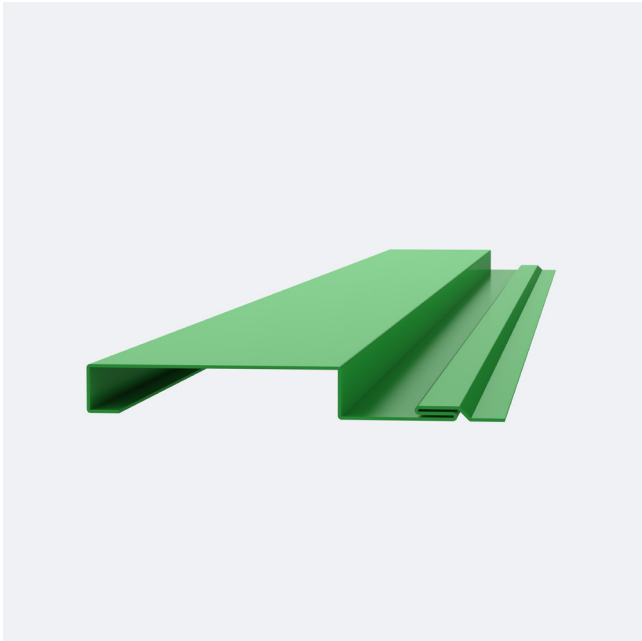

REVEAL FLUSH PANEL

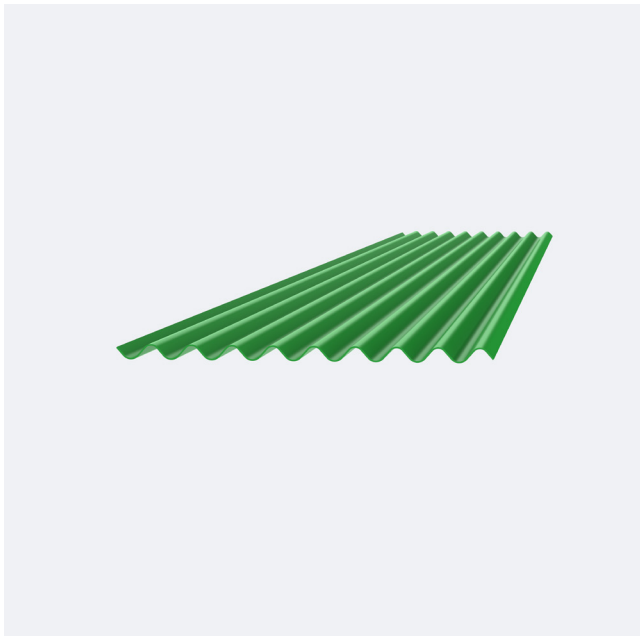

CORRUGATED PANEL

AWNINGS

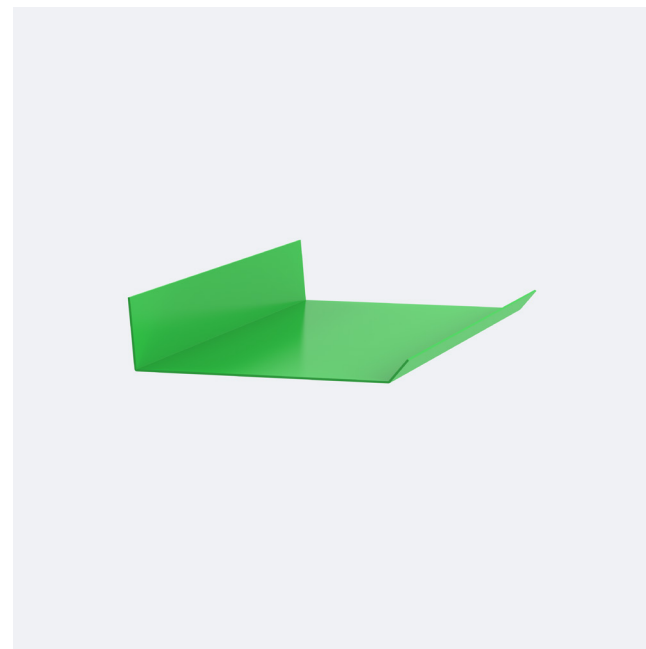

AWNING UP

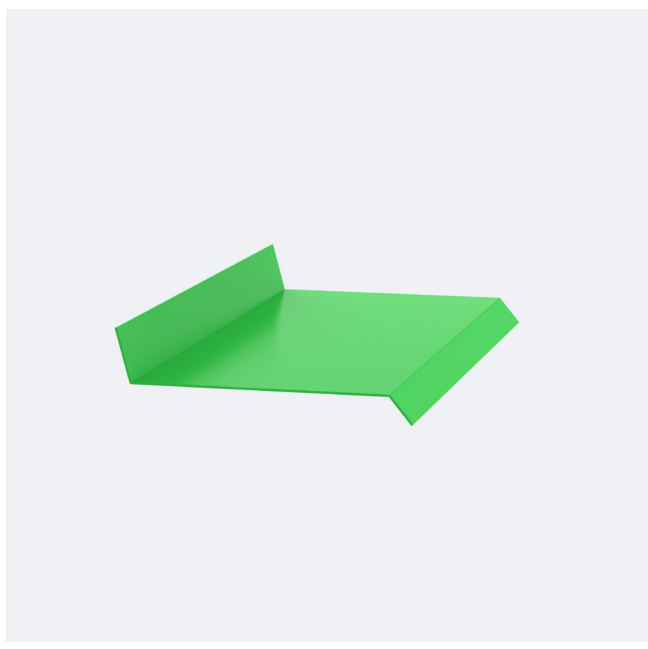

AWNING DOWN

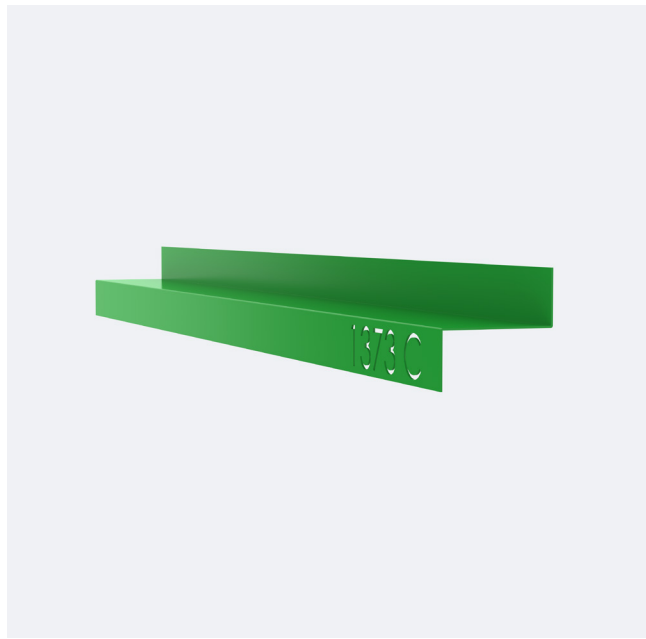

AWNING WITH HOUSE NUMBERS

HOUSE NUMBERS



HORIZONTAL HOUSE NUMBERS

CHOOSE FROM A VARIETY OF FONTS , SIZES, AND STYLES.

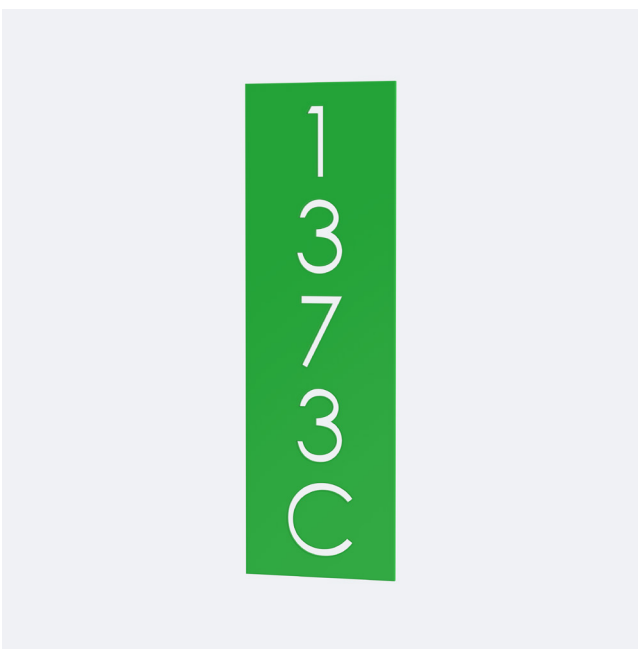

VERTICAL HOUSE NUMBERS

COLOR / PATTERN SELECTIONS

			
CM-REGAL WHITE	METALLIC SILVER	SANDSTONE	SURREY BEIGE
			
CHAMPAGNE	SIERRA TAN	MEDIUM BRONZE	WEATHERED COPPER
			
BRONZE	DARK BRONZE	MOCHA	TERRA COTTA
			
METALIC COPPER PENNY	COPPER PENNY	COLONIAL RED	RETRO RED

			
HARTFORD GREEN	EVERGREEN	HEMLOCK GREEN	FOREST GREEN
			
CITYSCAPE	SLATE GRAY	CHARCOAL	MATTE BLACK
			
WEATHERED ZINC	TWILIGHT BLUE	TAHOE BLUE	REGAL BLUE
			
OLD TOWN GRAY	OLD ZING GRAY	SLATE GRAY	

			
COPPER	VINTAGE	BONDERIZED	RUSTIC STEEL
			
GALVALUME PLUS	A606 WEATHERING STEEL	PREWEATHERED ZINC	ANODIZED ALUMINUM
			
FX BRIGHT NICKEL	FX RIVER ROCK	FX GUNMETAL	FX COAL CREEK
			
FX AGED GRANITE	FX PINE BRONZE	FX NIGHT SKY	FX IRON OXIDE

			
FX DESERT RUST	ACORN	GUNSTOCK	BARNBOARD
			
PONDEROSA	FRONTIER	HOMESTEAD	SADDLE
			
CANYON	WAGONWOOD	DURANGO	AUTUMN
			
HERITAGE 28 GUAGE	ESPRESSO		

VISIT / CONTACT **SEATTLE METALS**

12414 HWY 99, Shop #20
EVERETT, WA 98204
(last unit in building C)
Office: 206.765.6055
//
Sales@seattlemetalsinc.com

